



DUAL FUEL PIZZA OVEN CART BOTTOM
OWNERS MANUAL SKU #69577



USA Edition





READ THIS ENTIRE MANUAL CAREFULLY AND RETAIN FOR FUTURE REFERENCE

We care about your safety, so please....

- BE SURE YOUR GRILL CART IS PROPERLY ASSEMBLED AND CARED FOR. FAILURE TO FOLLOW THESE INSTRUCTIONS MAY RESULT IN SERIOUS BODILY INJURY AND/OR PROPERTY DAMAGE. IF YOU HAVE QUESTIONS CONCERNING ASSEMBLY OR OPERATION, CONSULT YOUR DEALER OR APPLIANCE SERVICE REPRESENTATIVE FOR ASSISTANCE.
- NOTE TO ASSEMBLER, PLEASE RETURN THIS MANUAL TO CONSUMER AFTER INSTALLATION.
- NOTE TO THE CONSUMER: RETAIN THIS MANUAL FOR FUTURE REFERENCE.
- THIS GRILL CART IS NOT INTENDED FOR USE IN OR ON RECREATIONAL VEHICLES AND/OR BOATS.

TABLE OF CONTENTS

PAGE# 2

PRODUCT WARRANTY AND REGISTRATION

HOW TO ORDER GRILL CART REPLACEMENT PARTS _____ **3**

DUAL FUEL PIZZA OVEN CART DETAILS

CART REPLACEMENT PARTS LIST / ILLUSTRATION _____ **4**

CART FASTENERS LIST FOR ASSEMBLY _____ **5**

CART ASSEMBLY INSTRUCTIONS

DUAL FUEL PIZZA OVEN CART ASSEMBLY _____ **5 - 12**

CLEANING & MAINTENANCE _____ **13**

LIMITED WARRANTY POLICY _____ **13-15**



WARNING: THIS PRODUCT CAN EXPOSE YOU TO CHEMICALS INCLUDING LEAD WHICH IS KNOWN TO THE STATE OF CALIFORNIA TO CAUSE BIRTH DEFECTS OR OTHER REPRODUCTIVE HARM. FOR MORE INFORMATION VISIT: www.P65Warnings.ca.gov



PRODUCT WARRANTY AND REGISTRATION

Thank you for choosing Bull Outdoor Products. To enable our commitment to your satisfaction, you will need to register your purchase for it to be covered under Bull's warranty policy. Please save your purchase receipt as it is required for warranty claims. Additionally, registering your purchase will allow Bull or your Bull Authorized Dealer to utilize the encoded information for the purpose of ordering replacement parts or additional accessories to ensure your purchase remains in optimal working condition. To validate your warranty, we offer two options as shown below:

OPTION 1 / Registering Online

Registration can be completed on the Bull Customer Service Portal, found here <https://api.bullbbq.com/c/>

OPTION 2 / Registering by Mail

Complete the Product Warranty Registration Card that will be in the shipping box (see reference)

Send to: BULL OUTDOOR PRODUCTS, INC.
15 East Ave. Athens, TN 37303
Attn: Warranty Service Center

Warranty Questions call Customer Service at (800) 521-2855

Bull Outdoor Products Warranty Registration Card 

Name _____ Date of Purchase _____

Place of Purchase _____

Email Address _____ Phone _____

Street Address _____ Apt # _____

City _____ State _____ Zip Code _____

How To Register

On Our Website: <https://api.bullbbq.com/c/>

Via Mail: Fill out this form and mail it to us!

Model Name: _____

Model Number: _____

Serial Number: _____

Scan This Code With Your Phone: 

UNPACKING THE SHIPPING BOX

Go to <https://bullbbq.com/bull-support-videos/> where we show you how to unbox, install components, and more.

AFTER OPENING THE SHIPPING BOX, INSPECT THE CONTENTS FOR ANY DAMAGE AND CONTACT OUR SERVICE CENTER OR LOCAL DEALER FOR THE REPLACEMENT OF ANY DAMAGED PARTS. IF DAMAGED DO NOT ATTEMPT INSTALLATION.

ORDERING REPLACEMENT PARTS

Please refer to your owner's manual parts list and illustration to identify what you need.

Below are options for ordering if you have not yet registered your purchase, please register on our website as soon as possible as this information is essential for ordering replacements.

To Order Replacement Parts online

go to: <https://bullbbq.com/buy-parts>

WARNING: USE OF ANY PART THAT IS NOT FACTORY AUTHORIZED WILL VOID WARRANTY AND MAYBE DANGEROUS.

MODEL AND SERIAL NUMBER LOCATIONS

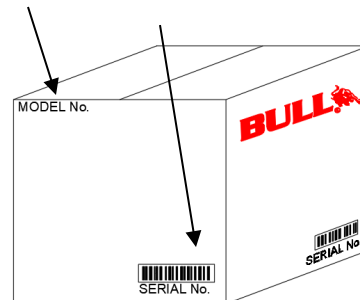

To Order Replacement Parts by Phone:

We have two Authorized Parts Distributors ready to assist.



Western Region
(800)258-6810

Eastern Region
(800)229-3056



NOTE: PLEASE COMPLETE THE FOLLOWING PRIOR TO ASSEMBLY:

1. Before attempting to assemble your dual fuel pizza oven cart, check that all the necessary parts are included by using the illustrated parts list.
2. Inspect parts for any damage and contact our service center or local dealer for replacement of any damaged parts.
3. Do not assemble or operate a dual fuel pizza oven cart that appears to be damaged.
4. For your safety, Bull recommends the assistance of another person when assembling larger and/or heavier items.

REPLACEMENT PARTS LIST

69577 DUAL FUEL PIZZA OVEN CART PARTS LIST WARRANTY ON ALL PARTS REPLACEMENT PARTS IS 1 YEAR			
ITEM #	BULL SKU #	DESCRIPTION	QUANTITY
1	69578	TOP SHELF	1
2	69579	SIDE SHELF (LEFT OR RIGHT)	2
3	69580	MIDDLE SHELF	2
4	69581	TRIANGLE REINFORCEMENT	4
5	69582	GAS TANK OPENING COVER	1
6	69583	BOTTOM SHELF	1
7	69584	LEG SUPPORT A	2
8	69585	LEG SUPPORT B	2
9	69586	GAS TANK RETENTION BOLT	1
10	16514	SWIVEL CASTER	4
	69587	ASSEMBLY HARDWARE KIT	1 KIT

PARTS ILLUSTRATION

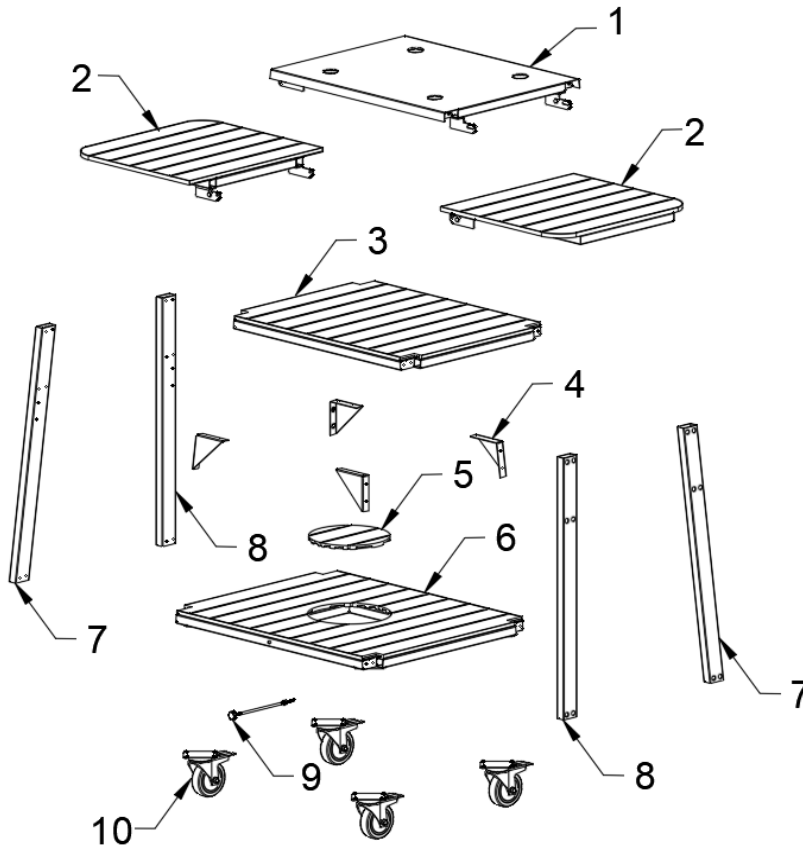

WARNING: USE OF ANY PART THAT IS NOT FACTORY AUTHORIZED WILL VOID WARRANTY AND MAYBE DANGEROUS.



CART FASTENERS FOR ASSEMBLY

- Before attempting to assemble your dual fuel pizza oven cart, check that all the fasteners are included using the list below.
- If any are missing contact our Service Center, or local dealer for replacement.

69577 DUAL FUEL PIZZA OVEN CART ASSEMBLY HARDWARE LIST (HARDWARE KIT SKU#69587)			
ILLUSTRATION ID #	DESCRIPTION, SIZE	QUANTITY	PURPOSE
11	ALLEN WRENCH (4mm)	1	ASSEMBLE VERTICAL SUPPORTS TO TOP & BOTTOM FRAMES & SHELF
12	HEX DRIVE BUTTON HEAD SCREW, M5 X 30	24	
13	FLAT WASHER, 5mm	24	
14	LOCK WASHER, 5mm	24	
15	PHILLIPS DRIVE SCREWDRIVER	1 required	ASSEMBLE GUSSETS TO VERTICAL SUPPORTS & SHELF
16	PHILLIPS DRIVE BUTTON HEAD SCREW, M5 X 12mm	16	
17	FLAT WASHER, 5mm	32	
18	ALLEN WRENCH (5mm)	1	ASSEMBLE CASTERS TO BASE FRAME
19	HEX DRIVE BUTTON HEAD SCREW, M8 X 20	16	
20	FLAT WASHER, 8mm	16	
21	LOCK WASHER, 8mm	16	

CART ASSEMBLY INSTRUCTIONS

Do not assemble or operate a dual fuel pizza oven cart that is damaged. For your safety, Bull recommends the assistance of another person when assembling larger and/or heavier items.

STEP #1: DUAL FUEL PIZZA OVEN CART ASSEMBLY SET UP

- Place cardboard or towel on the floor to prevent damage to the top of cart.
- Note: the cart is built upside down.
- The top is placed upside down on the cardboard or towel.

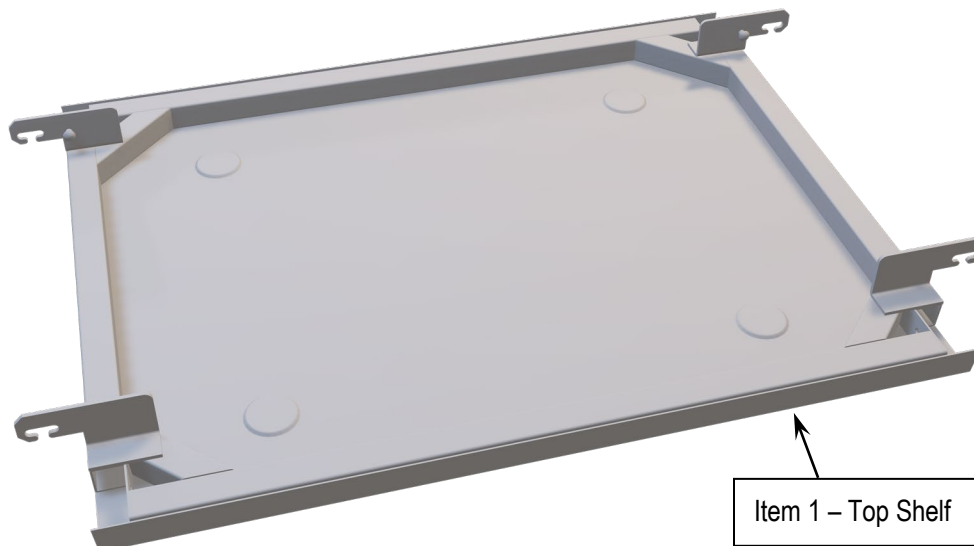

Item 1 – Top Shelf



STEP #2 ATTACH VERTICAL SUPPORTS TO TOP

Per illustration below, attach vertical supports A and B to the cart top using M5 x 30MM long Screws (x8), 5MM lock washer (x8), and 5MM washer (x8) with the 3MM supplied Allen wrench.

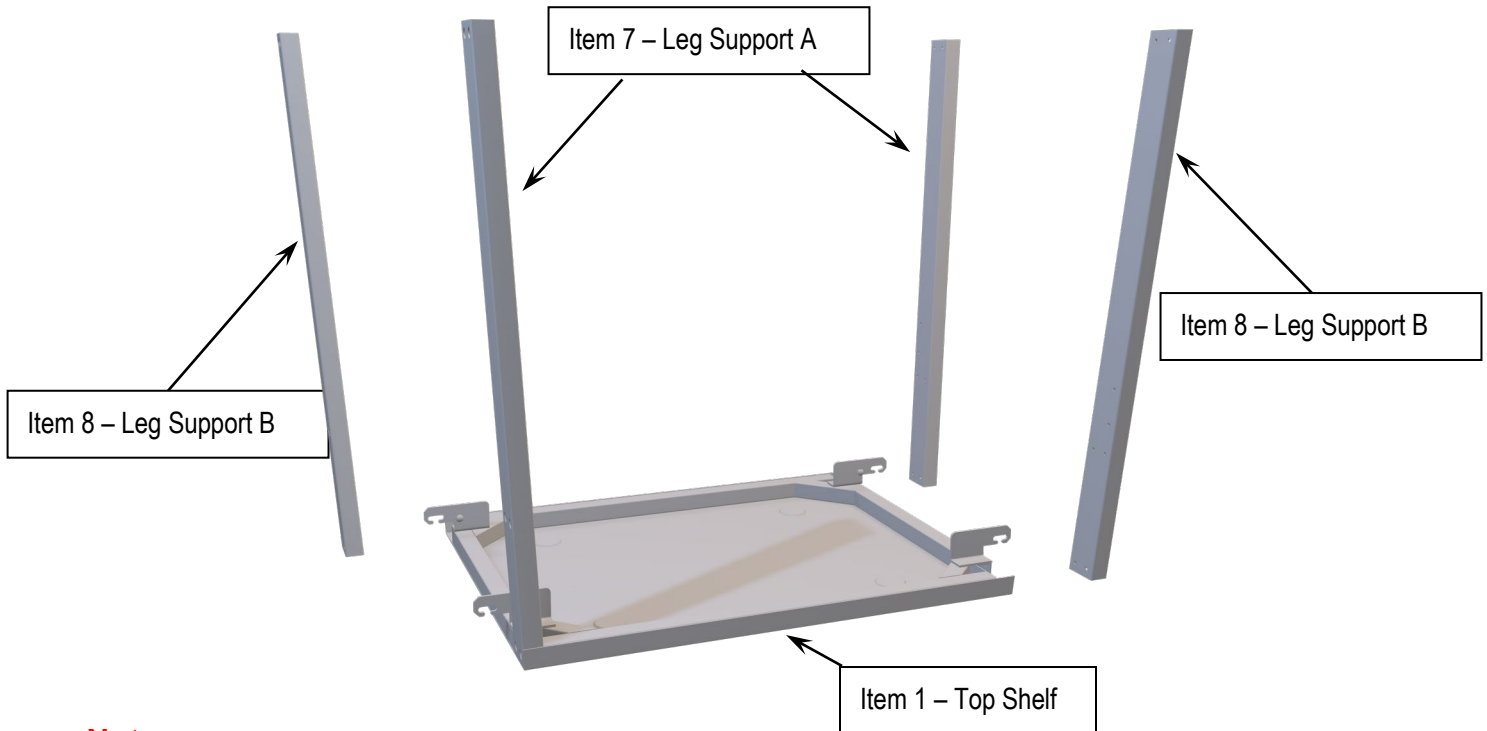

Note:



All vertical supports lean outward.

Do not tighten screws. Leave movement in the supports to ease assembly of the drawer, gussets, and bottom frame. Tightened after assembled.

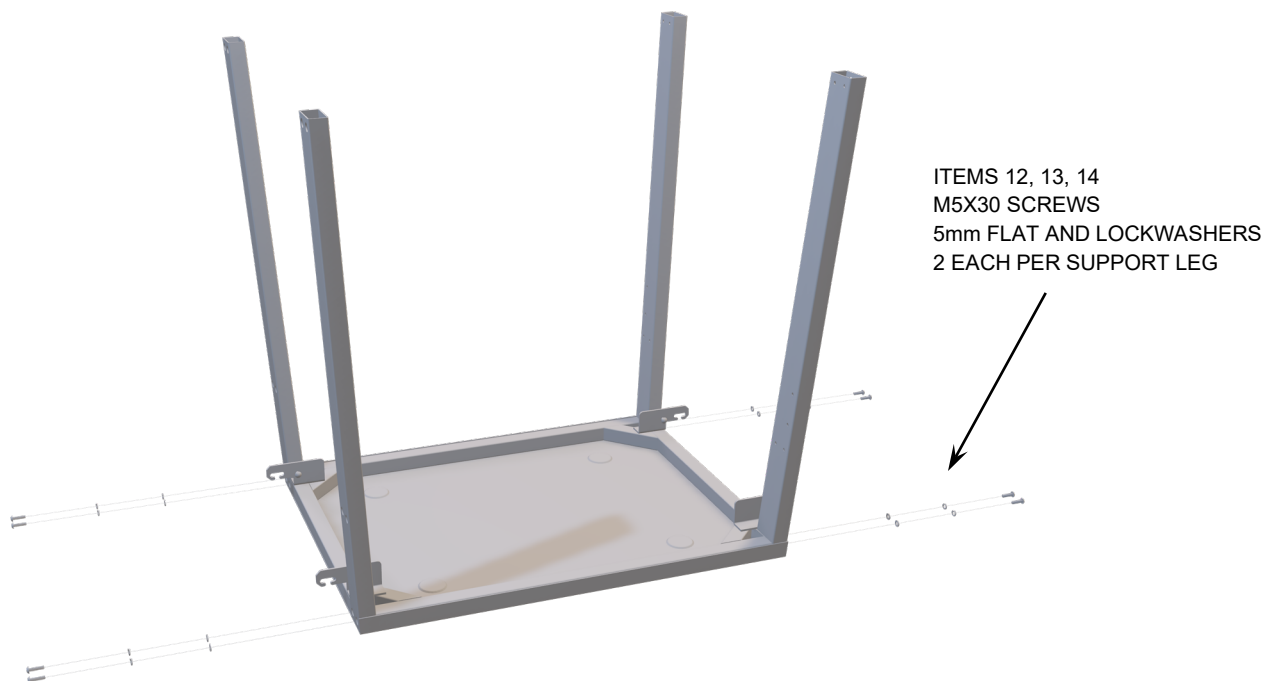



STEP #3 ADD SHELF TO ASSEMBLY

Per illustration below, slide the shelf down the vertical supports A and B to align the holes.

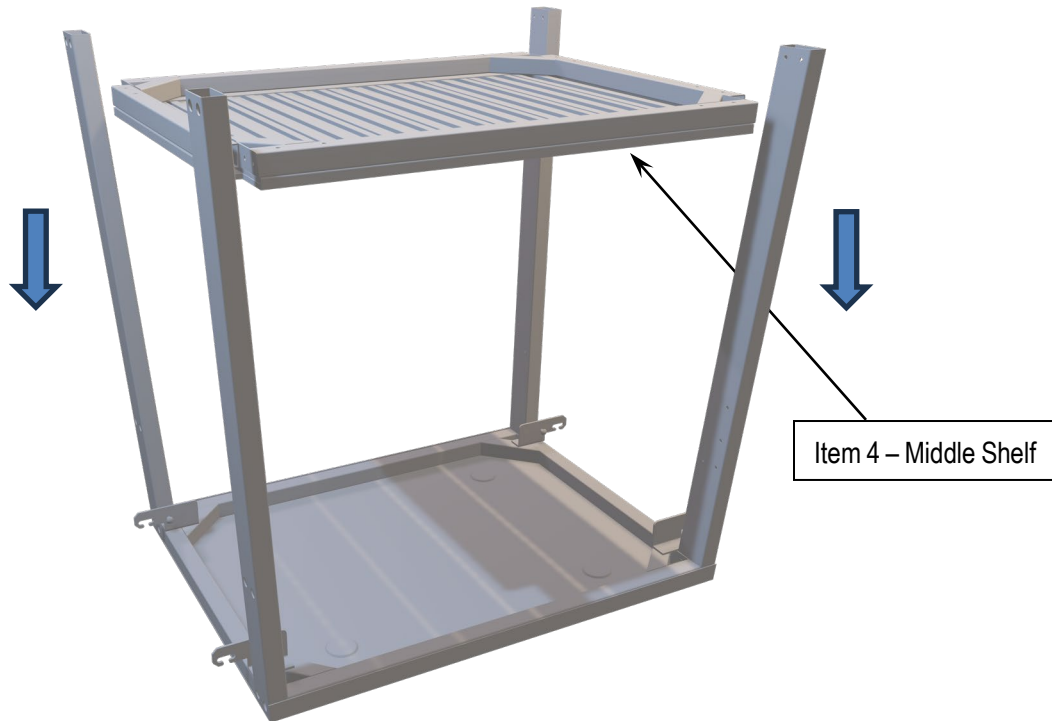

Insert the M5 x 30MM long Screws (x8), 5MM lock washer (x8), and 5MM washer (x8), to be screwed in with the 3MM supplied Allen wrench. Do not tighten. Leave movement in the vertical supports.

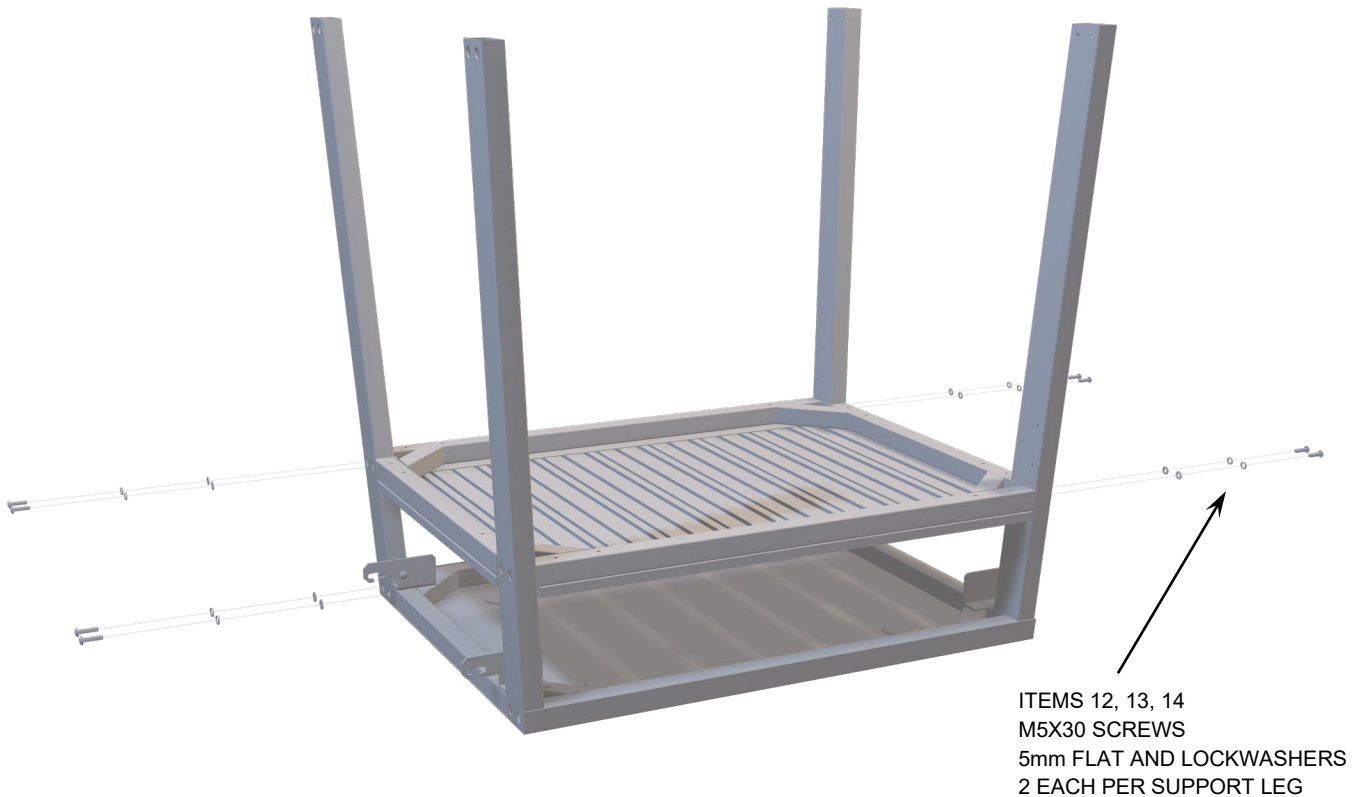



4: ATTACH GUSSETS TO SHELF AND VERTICAL SUPPORTS

Place the gussets against the bottom of the shelf and vertical supports with the flat side of the gussets to the outside of the cart. Attach the gussets by using the M5 x 12MM Philips head screws (x16) and M5 flat washers (x16) using a Philips head screwdriver (not supplied).

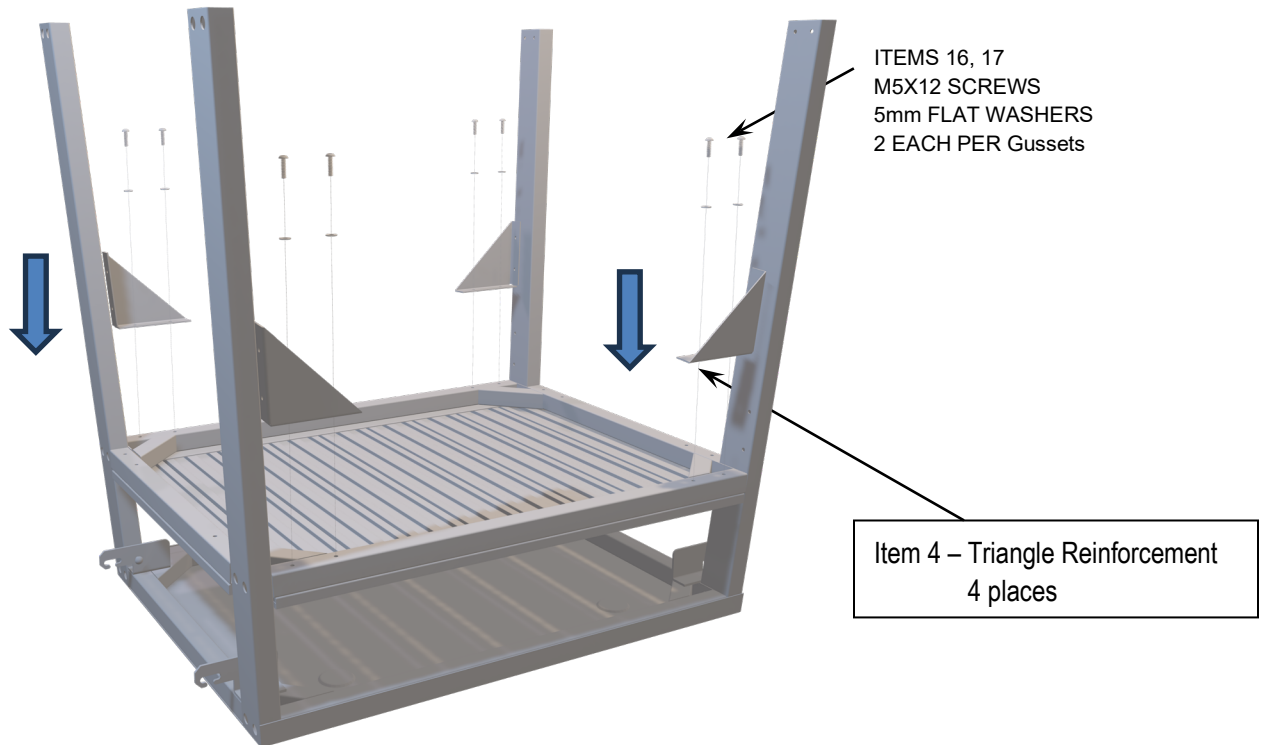

Screw the M5 x 12MM long Screws (x16) and 5MM flat washer (x16), thru the gussets to the vertical supports using a Phillips head screwdriver. Do not tighten. Leave movement in the vertical supports.

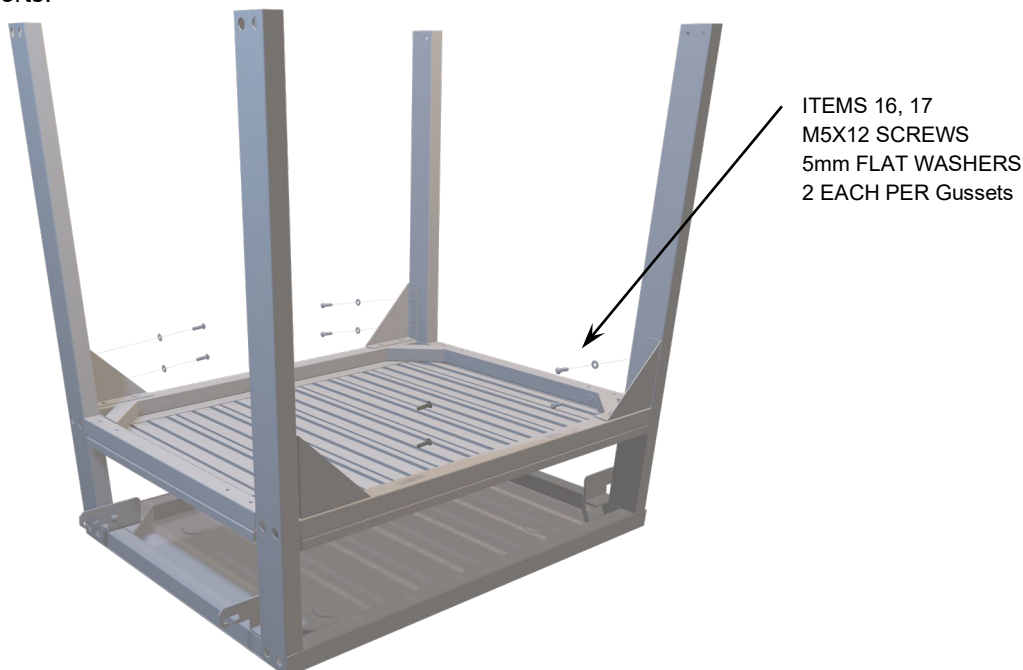

Note: The vertical supports still need a small amount of freedom of movement.



5: ADD BASE TO ASSEMBLY

Lower the base onto the assembly. Align the holes on the base with the holes on the vertical supports.

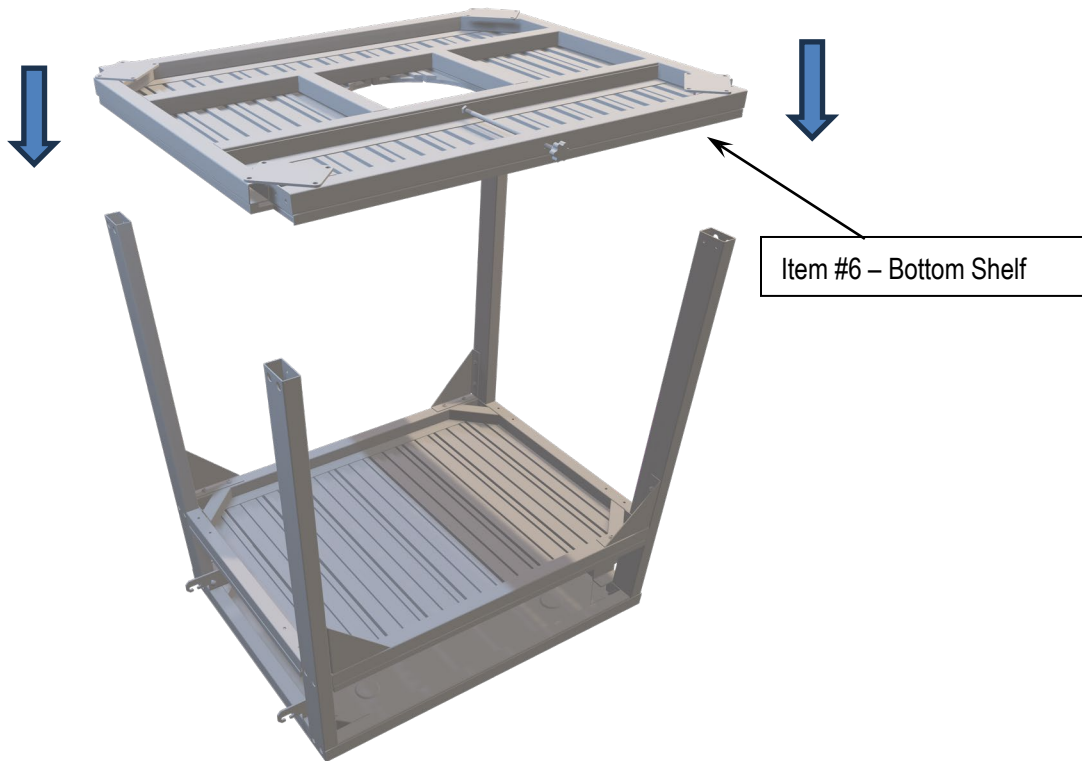

Insert the last of M5 x 22MM long Screws (x8), 5MM lock washer (x8), and 5MM washer (x8), through the vertical supports to the bottom frame with the 3MM supplied Allen wrench.

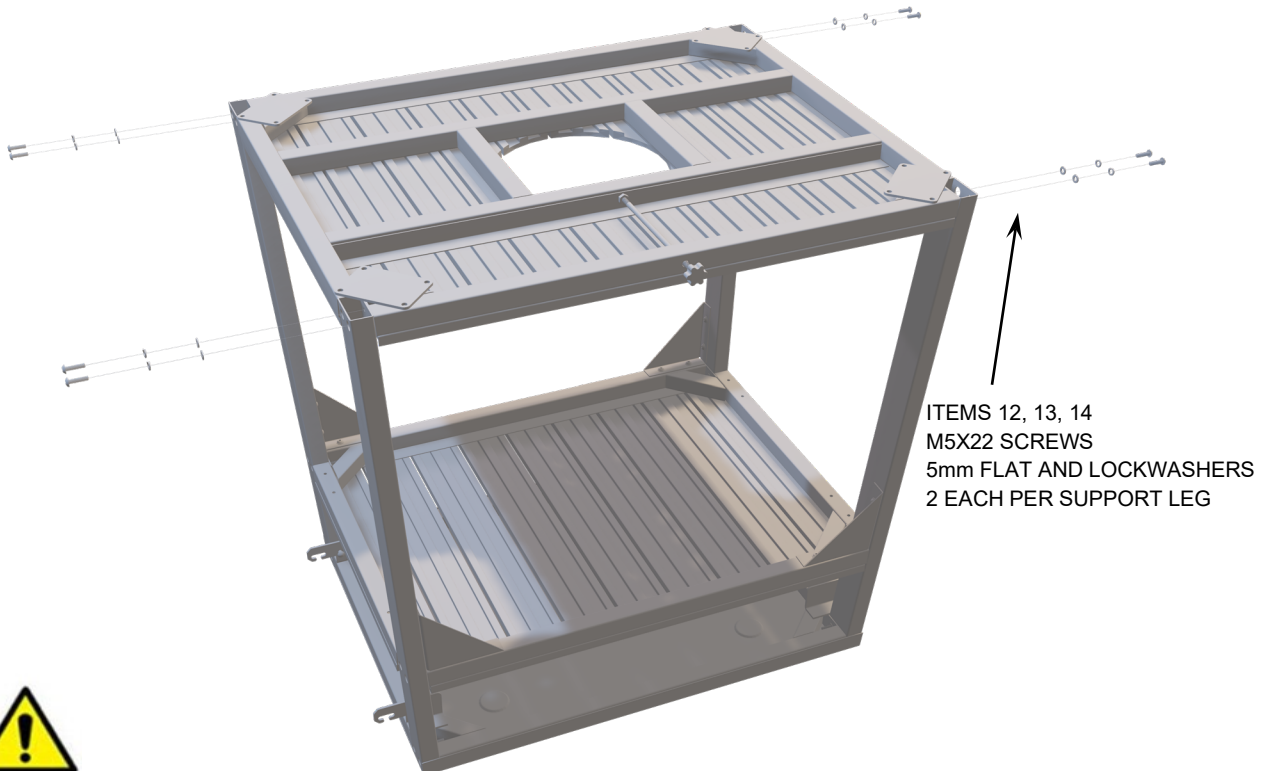

Now, go back and tighten all the screws installed.



6: INSTALL CASTERS TO BASE

Attach casters (x4) to base with M8 x 20MM long screws (x16), M8 lock washer (x16), and M8 flat washer (x16) with the M5 Allen wrench.

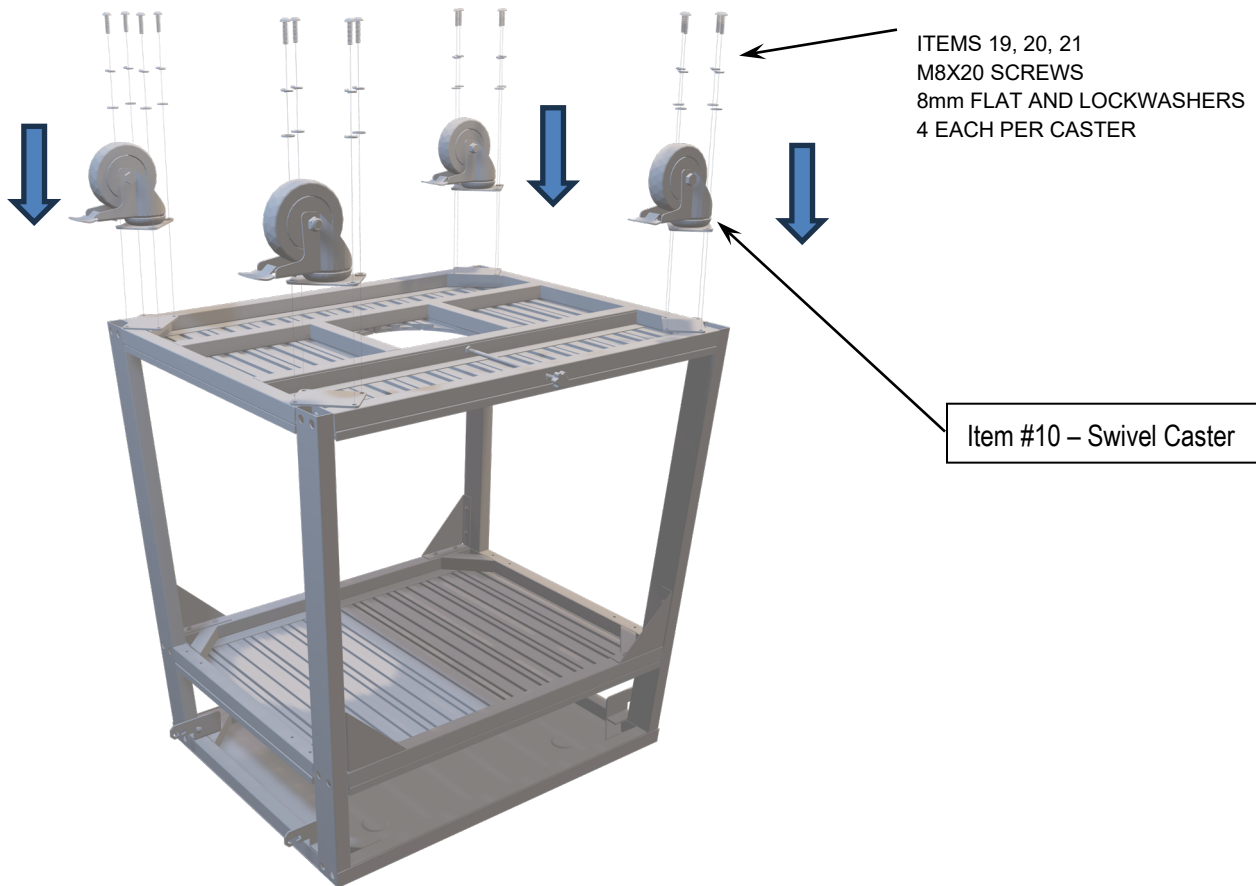

7: STAND CART ON THE WHEELS

Lift and rotate the assembly setting it on the casters. (Bull recommends using two people for safety.)
If not using a propane tank, place the propane base plug into place.

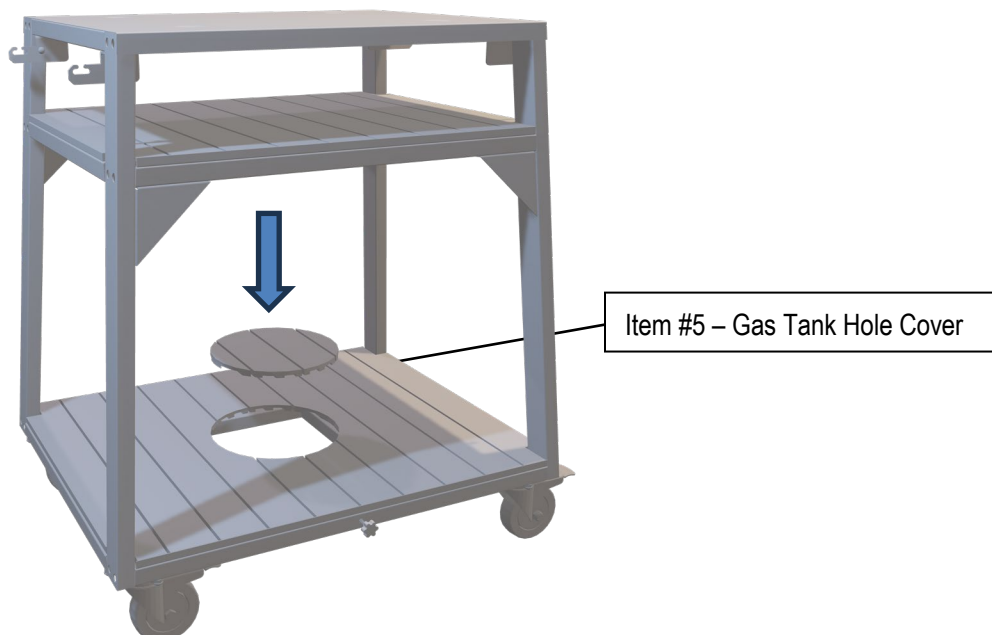



8: PLACING THE WINGS ON THE CART ASSEMBLY

Slide the pins on the wing hinges into the opening of the slots on the cart top hinges.

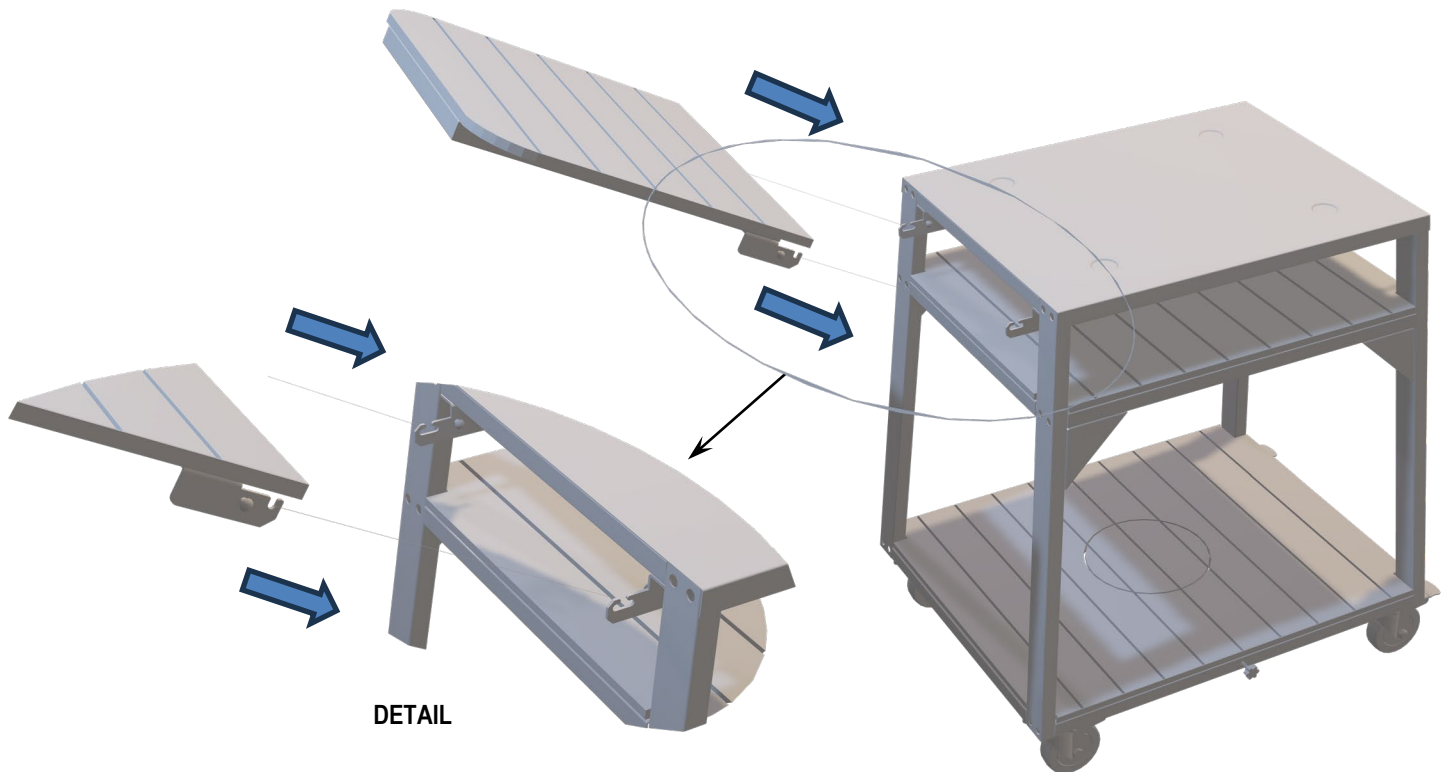

9: FOLDING THE WINGS DOWN OR OUT

With the pins in the slots, you can either pull the wings outward then fold the wing down. Or push the wings in and leave the wings level with the top.

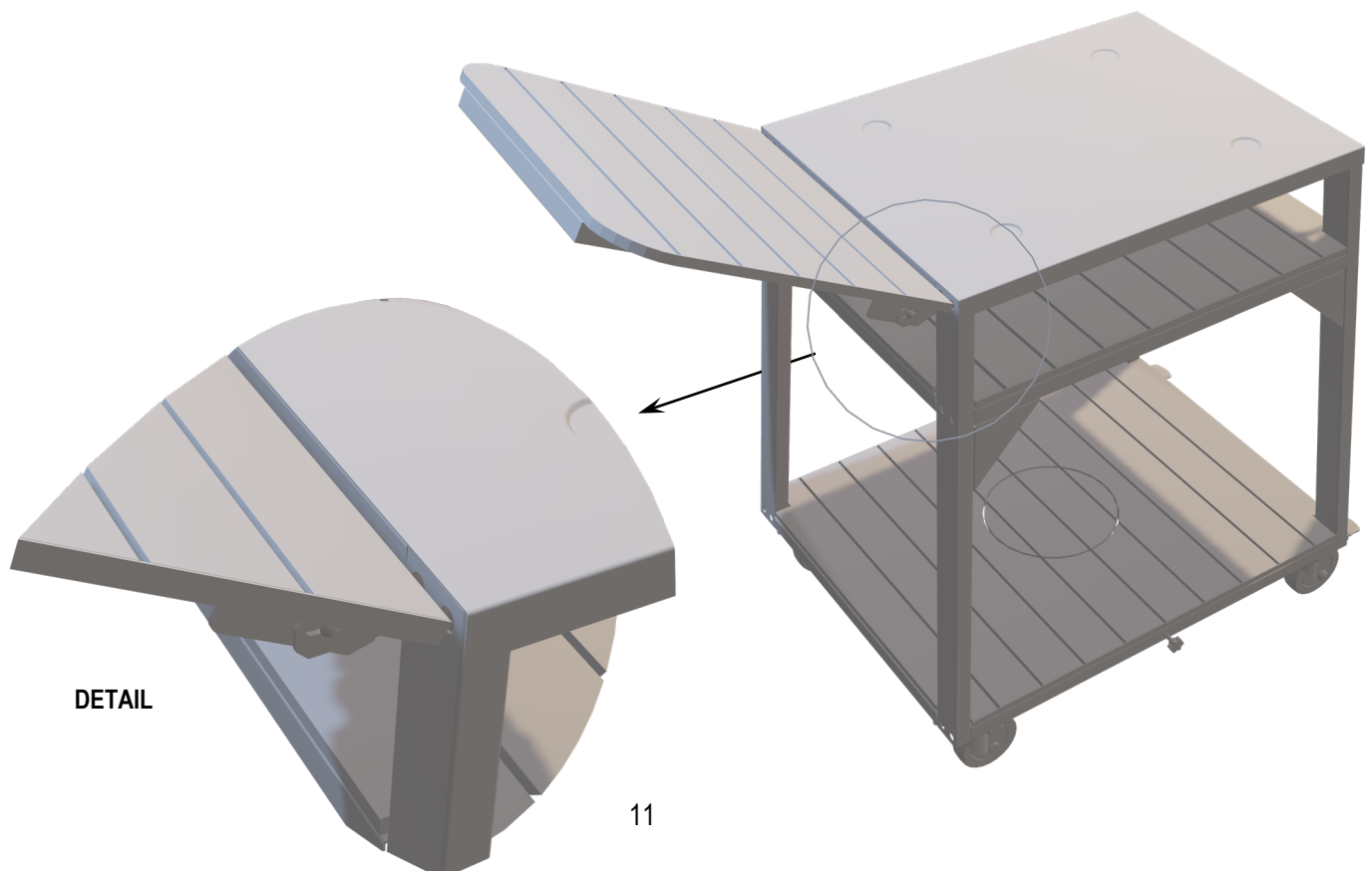



10: PLACING THE DUAL FUEL PIZZA OVEN ON THE CART ASSEMBLY

The cart assembly is complete. Fold the cart wings down. With 2 people place the dual fuel pizza oven on the cart. Note: Warning, lock casters before placing pizza oven on cart. The dimples on the top plate of the top of the cart assembly are where the rubber foot pads on the pizza oven made to reduce the potential of the oven from sliding.

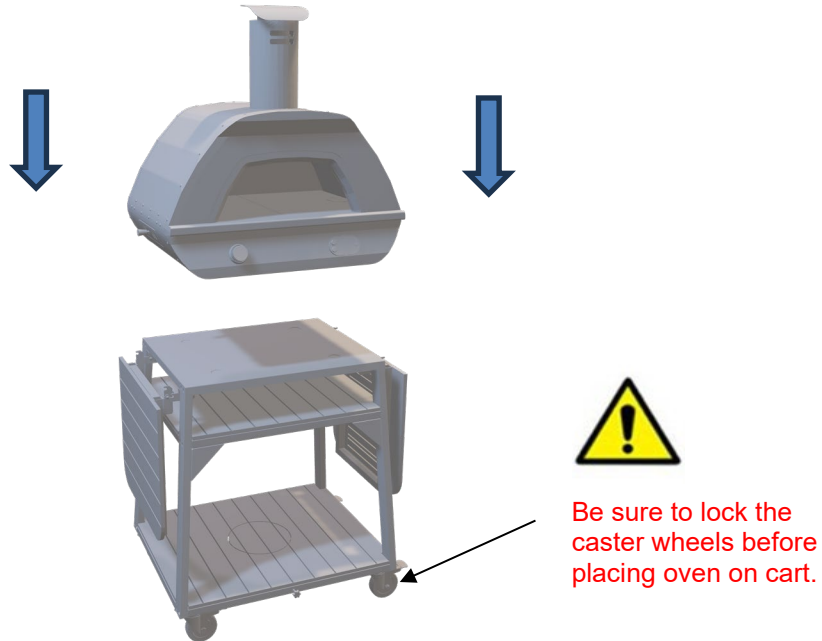

11: PLACING THE PROPANE TANK ON CART ASSEMBLY

If a propane tank will be used. Place the tank into hole in the bottom of the cart assembly and secure it to base. Attach the pressure regulator and hose to the propane tank and the back of the dual fuel pizza oven.



Your dual fuel pizza oven cart is now completely assembled. Please continue to read the next section your Dual Fuel Pizza Oven to understand all safety, warning and usage instructions for your Dual Fuel Pizza Oven manual before use.



CLEANING AND MAINTENANCE

WARNING: BEFORE CLEANING YOUR CART MAKE SURE YOUR GRILL AND CART ARE COOL ENOUGH TO BE TOUCH.

CART CLEANING:

Washing the cart is not necessary, but periodically it is suggested you wash the cart using a soap and warm water solution. Use only a nylon brush to remove stubborn residue. Dry the cart before the next use.

STAINLESS STEEL CLEANING AND MAINTENANCE OF DUAL FUEL PIZZA OVEN

Stainless steel is a corrosion resistant chromium/nickel alloy steel that is both durable as well as strong with an outstanding luster. The goal of your cleaning and maintenance routine should be to keep the stainless steel's protective chromium oxide layer intact. This is what prevents corrosion. Contrary to popular belief, stainless steel is **NOT** rust proof, especially in the environment of a swimming pool. Chlorine, bromine, some fertilizers and other elements are extremely caustic chemicals for stainless steel. These chemicals combined with heat and humidity increase the corrosiveness of these chemicals. Regular cleaning is the best way to prevent corrosion and add years of enjoyment to your Bull Stainless Steel products.

Warranty Policy

LIMITED WARRANTY ON BULL OUTDOOR PRODUCTS, INC., PRODUCTS

THIS LIMITED WARRANTY GIVES YOU SPECIFIC LEGAL RIGHTS. YOU MAY ALSO HAVE OTHER RIGHTS, WHICH VARY FROM STATE TO STATE.

THIS LIMITED WARRANTY CAN ALSO BE FOUND ON OUR WEBSITE AT:

<https://www.bullbbq.com/support-warranty> (United States Customers)

<https://www.bullbbq.eu/customer-care/#warranty-registration-form> (International Customers)

AND IN THE OWNER'S/INSTALLATION MANUALS THAT WE PROVIDE WITH OUR PRODUCT

THIS LIMITED WARRANTY IS SUBJECT TO THE EXCLUSIONS, CONDITIONS AND LIMITATIONS SET FORTH BELOW.

ANY IMPLIED WARRANTIES IMPOSED BY LAW, INCLUDING WITHOUT LIMITATION TO THE IMPLIED WARRANTIES OF MERCHANTABILITY AND FITNESS FOR A PARTICULAR PURPOSE, ARE LIMITED IN DURATION TO THE DURATION OF THIS EXPRESSED LIMITED WARRANTY. SOME STATES DO NOT ALLOW LIMITATIONS ON HOW LONG AN IMPLIED WARRANTY LASTS, SO THE ABOVE LIMITATION MAY NOT APPLY TO YOU.

WHO MAY USE THIS WARRANTY?

BULL OUTDOOR PRODUCTS, INC. located at address 15 East Ave. Athens, TN 37303

("We") extend this limited warranty only to the consumer who originally purchased the product ("you") at the original site of delivery or installation. It does not extend to any subsequent owner or other transferee of the product. It does not extend to any rental, commercial, or non- residential application. Examples of excluded applications include, but are not limited to day care centers, schools, bed and breakfast centers, churches, private clubs, fire stations, club houses, Common areas in multi-family dwellings, restaurants, hotels, nursing homes, food service locations, and institutional food service locations.

WHAT DOES THIS WARRANTY COVER?

This limited warranty covers defects in materials and workmanship of the product and product components identified below for the Warranty Periods defined below.



Warranty Policy (Continued)

WHAT IS THE PERIOD OF COVERAGE?

This limited warranty starts on the date of your purchase and lasts for the time periods specified on the next page. The Warranty Period is not extended if we replace the product. We may change the availability of this warranty at our discretion, but any changes will not be retroactive.

Grilling/Pizza Accessories and Grill Covers DO NOT include a warranty period

Grill Warranty Periods

The following parts are covered for **1 year** on all our current gas grill models:

- The lid, control panel, grease tray, bezels, knobs, temperature gauge, valves, regulator, flex tubes, rotisserie burner, transformer, and all components of the lighting system.

The following parts are covered for **3 years** on all our current gas grill models:

- The manifold, handle end caps, flame tamers, heat shields, and warming rack.

The following parts are covered for the **Lifetime** on all our current gas grill models:

- Insert assembly and the grates.

The warranty period for the grill burners varies by type:

- Cast stainless steel burners - **Lifetime**
- Welded stainless steel burners – **5 years**
- Porcelain coated burners – **3 years**

The warranty period for the charcoal grill is **1 year** on all parts, except for the insert assembly, which is covered for **5 years**.

Component Warranty Periods

All the parts for our components /grill carts/refrigerators/kegerators/drawers/doors/refrigerator frames/grill jackets/finishing frames/ice chest/sinks/bar center and vent hoods are covered for **1 year** with these exceptions:

- **Power Burner**

- The insert/grates are **lifetime** covered parts.
- The manifold/burner are covered for **3 years**.

- **Searing Station/Slide in Double Sideburner**

- The grates are covered for **lifetime**,
- The insert for **5 years**, and
- The manifold for **3 years**.

- **Single Sideburner**

- The grates are covered for **5 years** and the burner for **3 years**.

- **Sidekick**

- The burner is covered for **3 years**.

- **Heaters**

- The heater replacement parts are covered for **3 years**.

- **Pizza Ovens/Islands/Fire Features Warranty Periods**

- All of the parts and construction materials are covered for **1 year**.



Warranty Policy (Continued)

WHAT DOES THIS WARRANTY NOT COVER?

This limited warranty does not cover any damage due to:

- Transportation.
- Storage
- Improper installation or use.
- Use on improper fuel/gas supply.
- Failure to follow the product instructions or to perform any preventive maintenance.
- Modifications.
- Normal wear and tear, rust, corrosion, oxidation, or discoloration.
- External causes such as accidents, abuse, or other actions or events beyond our reasonable control.

WHAT OPTIONS ARE OFFERED BY BULL OUTDOOR PRODUCTS UNDER THIS WARRANTY?

With respect to any defective product claim made during the Warranty Period, we will, in our sole discretion:

- Replace such product (or the defective part) free of charge.

WHAT IS EXCLUDED BY BULL OUTDOOR PRODUCTS UNDER THIS WARRANTY?

- We will not pay for shipping charges for replacement parts, or for any labor or labor related charges.
- We will not pay for any accessory products or ancillary products purchased by you for use in connection with the product.

HOW DO YOU NOTIFY BULL CUSTOMER SERVICE OF A POTENTIAL WARRANTY ISSUE?

Our Customer Service is ready to help. Here's how to reach us:



By Phone (800) 521-2855 Monday through Friday from 8:00 a.m. to 5:00 p.m. (EDT)



To submit a warranty, claim on-line or message go to <https://www.bullbbq.com/support-warranty.com>